

Paleomagnetism

Table of Contents

- [Overview](#)
- [Superconducting Rock Magnetometer \(SRM\)](#)
- [AGICO JR-6A Spinner Magnetometer](#)
- [D-TECH D-2000 Alternating-Field \(AF\) Demagnetizer](#)
- [Icefield MI-5 Multishot Orientation Tool](#)
- [Flex-IT Orientation Tool](#)
- [Kappabridge \(Magnetic Susceptibility Meter\)](#)
- [Paleomagnetism Lab Support Equipment](#)
- [PmagPy](#)

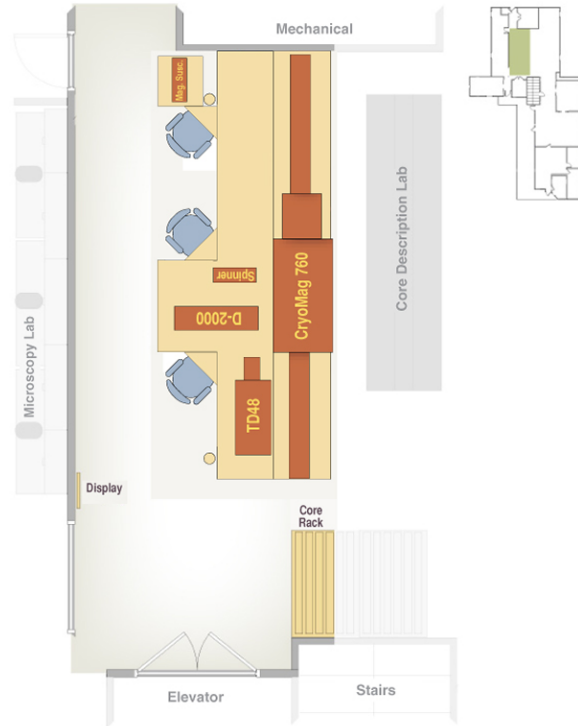

Layout of the Paleomagnetism Lab on the Core Deck. Top of the image is towards the front of the ship.

Overview

Shipboard paleomagnetists conduct paleomagnetic and rock magnetic measurements of recovered rocks and sediment for a variety of studies, such as those on magnetostratigraphy, geomagnetism, tectonics, and environmental change. Typically measurements are conducted on the archive half of each core using the 2G Enterprises 760-4K Superconducting Rock Magnetometer (SRM). In addition, discrete samples (~6-10 cm³ paleomagnetic cubes or mini-cores) may be taken from the working half of cores for additional measurements using the SRM or spinner magnetometers as well as other instruments in the lab.

Superconducting Rock Magnetometer (SRM)

- [SRM Quick Start Guide](#)
- [SRM User Guide](#)
- [Shanghai SRM Assessment 2017-07-19](#)

AGICO JR-6A Spinner Magnetometer

- [JR-6A Spinner Magnetometer Quick Start Guide](#)
- [Agico orientation parameters](#)

D-TECH D-2000 Alternating-Field (AF) Demagnetizer

- [DTech AF Demagnetizer User Guide](#)

Icefield MI-5 Multishot Orientation Tool

- [MI5 Multishot Orientation Tool User Guide](#)
- [MI5 Multishot Orientation Tool Quick Start Guide](#)

- [MI5 CreateInclinFile.exe Quick Start Guide](#)
- [Orientation Tool Flow Chart Instructions](#)

Flex-IT Orientation Tool

- [FlexIT Orientation Tool User Guide](#)

Kappabridge (Magnetic Susceptibility Meter)

- [Kappabridge User Guide](#)

Paleomagnetism Lab Support Equipment

- [Cryomech Compressor and Haskris Chiller](#)
- [Paleomagnetic Standards](#)

PmagPy

- [PmagPy User Guide](#)

[\[Table of Contents \]](#) [\[Overview \]](#) [\[Superconducting Rock Magnetometer \(SRM\) \]](#) [\[AGICO JR-6A Spinner Magnetometer \]](#) [\[D-TECH D-2000 Alternating-Field \(AF\) Demagnetizer \]](#) [\[Icefield MI-5 Multishot Orientation Tool \]](#) [\[Flex-IT Orientation Tool \]](#) [\[Kappabridge \(Magnetic Susceptibility Meter\) \]](#) [\[Paleomagnetism Lab Support Equipment \]](#) [\[PmagPy \]](#)